

# Product Information Sheet

COMMISSION DELEGATED REGULATION (EU) 2019/2015 with regard to energy labelling of light sources

**Supplier's name or trade mark:** Source

**Supplier's address:** SGD Limited, Unit 7/8 Ashbourne Business Centre, Ballybin Road, Ashbourne, Co. Meath. A84 YP58. Ireland.

**Model identifier:** SSL20W

## Type of light source:

Lighting technology used:	LED	Non-directional or directional:	NDLS
Light source cap-type (or other electric interface)	SMD		
Mains or non-mains:	NMLS	Connected light source (CLS):	No
Colour-tuneable light source:	No	Envelope:	-
High luminance light source:	No		
Anti-glare shield:	No	Dimmable:	No

## Product parameters

Parameter	Value	Parameter	Value
-----------	-------	-----------	-------

### General product parameters:

Energy consumption in on-mode (kWh/1000 h), rounded up to the nearest integer	20	Energy efficiency class	F
Useful luminous flux ( $\phi_{use}$ ), indicating if it refers to the flux in a sphere (360°), in a wide cone (120°) or in a narrow cone (90°)	2 000 in Wide cone (120°)	Correlated colour temperature, rounded to the nearest 100 K, or the range of correlated colour temperatures, rounded to the nearest 100 K, that can be set	4 000
On-mode power ( $P_{on}$ ), expressed in W	20,0	Standby power ( $P_{sb}$ ), expressed in W and rounded to the second decimal	-
Networked standby power ( $P_{net}$ ) for CLS, expressed in W and rounded to the second decimal	-	Colour rendering index, rounded to the nearest integer, or the range of CRI-values that can be set	82
Outer dimensions	Height	Spectral power distribution in the	See image in last page
	Width		
			85

without separate control gear, lighting control parts and non-lighting control parts, if any (millimetre)	Depth	60	range 250 nm to 800 nm, at full-load	
Claim of equivalent power <sup>(a)</sup>		-	If yes, equivalent power (W)	-
			Chromaticity coordinates (x and y)	0,378 0,377
<b>Parameters for LED and OLED light sources:</b>				
R9 colour rendering index value		2	Survival factor	1,00
the lumen maintenance factor		-		

(a) : not applicable;

(b) : not applicable;

# INSTALLATION INSTRUCTIONS

PRODUCT CODE: SSL20W



## Safety Information

Please read these instructions carefully before installing this product and store in a safe place for future reference. This fitting should be installed by a qualified electrician and must comply with IEE regulations. Install on a flat even surface. The fitting is IP65 rated. When the LEDs expire, the fitting must be replaced

## Lamp Specification

Colour Temp:	4000k
Wattage:	20W
IP Rating:	IP65
Class:	Class 1, (must be earthed)

## Installation

1. Isolate the power supply before beginning installation
2. Position where the fitting will be fixed to the wall and mark the position of the fixing holes on the wall
3. Secure the fitting to the wall using suitable fixings
4. Pass the supply cable through the cable gland and terminate the supply cable into the terminal block.
5. Neutral - Blue, Earth - Green/Yellow, Live - Brown
6. Re-attach the front cover using the retained screws making sure the seal is properly aligned
7. Turn the mains power back on and test the luminaire

## Cleaning

Disconnect the power and only clean the exterior of this fitting. Clean this product with a soft dry cloth. Never use any chemical or abrasive cleaners.

## Product end of life instruction.

This Lighting product is in the scope of EU 2019/2020 directive on Waste Electrical and Electronic Equipment (WEEE). This product must be disposed according to the legislation. This document is intended for use by end of life recyclers or treatment facilities. It provides the basic information to assure an appropriate end of life treatment for the components and materials of the product. Please follow pictured diagram showing how to dismantle the product into different components which should be disposed of correctly. These components consist of plastic, metal and electronic materials. It is the responsibility of the end user to dispose of this product correctly. [www.weeeireland.ie](http://www.weeeireland.ie) or contact your local council for further information.

## Disassembly Diagram

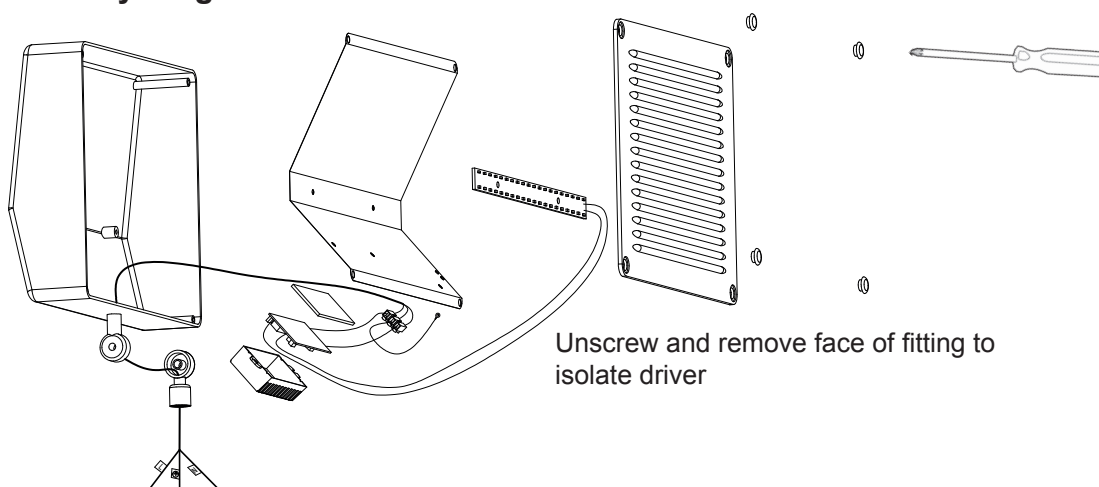

## SIZE

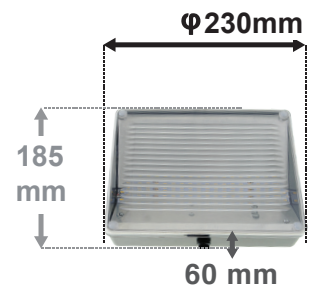

## Installation Diagram

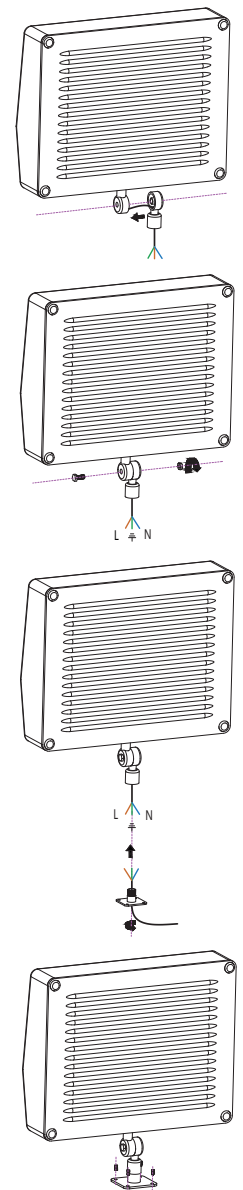

For more information contact:

Unit 7/8 Ashbourne Business Centre, Ballybin Road, Ashbourne, Co. Meath, Ireland, A84 YP58,  
Phone: 00353 1 835 7447



Solas Geal Distribution

Unit 32 Junction One Business Park, Valley Road, Birkenhead, Merseyside, UK, CH41 7ED,

UK Ph: 0330 551 7000

Website: [www.sgd.ie](http://www.sgd.ie)



# Spectrum Test Report

Sample : SSL20W  
Sample No. : 16  
Manufacturer : SGD LIMITED

Date : 2021-12-30 10:48:09  
Sam. Status :  
Instrument : HAAS-2000

## Test Condition

Temperature : 25.3Deg  
WL Range : 350nm-1000nm  
Test Mode : Fast Test

RH : 65.0%  
IP : 39716 (61%)  
T : 242 ms  
Sensitivity : High

## Spectrum

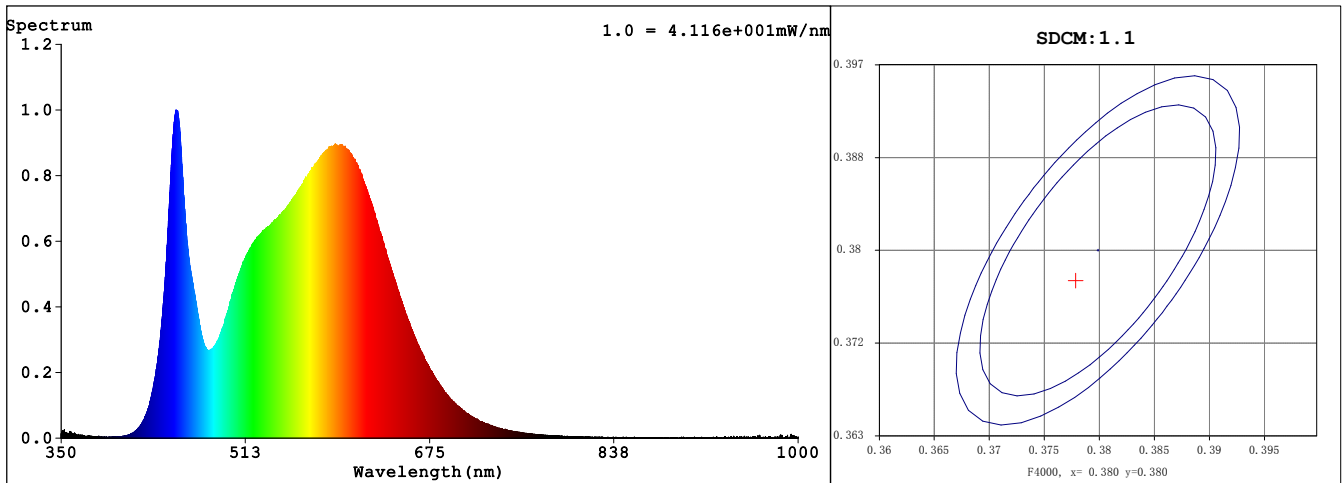

## Colorimetric Parameters

Chromaticity Coordinate:  $x = 0.3780$   $y = 0.3773$  /  $u' = 0.2233$   $v' = 0.5014$  ( $duv=9.68e-04$ )

CCT= 4071K Prcp WL:  $L_d=578.3nm$  Purity=26.7%

Peak WL:  $L_p=451nm$  FWHM: =22.8nm Ratio:R=18.0% G=78.3% B=3.7%

Render Index:  $R_a = 82.3$

R1 =80 R2 =89 R3 =95 R4 =81 R5 =81 R6 =85 R7 =85  
R8 =62 R9 =2 R10=74 R11=80 R12=61 R13=83 R14=98 R15=74

LEVEL:OUT

## Photometric & Radiometric Parameters

Flux = 2107.5 lm Eff. : 114.33 lm/W Fe = 6.3384 W

## Electrical parameters

V = 230.2 V I = 0.08413 A P = 18.43 W PF = 0.9519 F=49.99 Hz



## **EU DECLARATION OF CONFORMITY**

**Manufacturers Name:** Solas Geal Distribution  
Unit 7/8 Ashbourne Business Centre, Ballybin Road, Ashbourne, Co. Meath, A84 YP58.

**Declaration Number:**  
0026 – SSL20W

This declaration of conformity is issued under the sole responsibility of the manufacturer.

**Products:**  
LED SIGN LIGHT

**Model Number:**  
SSL20W

The product/model of the declaration described above is in conformity with the relevant community harmonisation legislation:

Directive 2014/35/EU – Low Voltage Directive

The product/model of the declaration described above is in conformity with the standards and technical specifications listed below:

EN IEC 60598-2-1:2021; EN IEC 60598-1:2021; EN 62493:2015;  
EN IEC 62031:2020; EN 61347-1:2015+A1:2021;  
EN 61347-2-13:2014+A1:2017



*Signed:*

*Date:*

*Place of Issue: Republic of Ireland*

