

Product Information Sheet

COMMISSION DELEGATED REGULATION (EU) 2019/2015 with regard to energy labelling of light sources

Supplier's name or trade mark: Source

Supplier's address: SGD Limited, Unit 7/8 Ashbourne Business Centre, Ballybin Road, Ashbourne, Co. Meath. A84 YP58. Ireland.

Model identifier: SLIM SQ 12W CCT

Type of light source:

Lighting technology used:	LED	Non-directional or directional:	DLS
Light source cap-type (or other electric interface)	N/A		
Mains or non-mains:	NMLS	Connected light source (CLS):	No
Colour-tuneable light source:	No	Envelope:	-
High luminance light source:	No		
Anti-glare shield:	No	Dimmable:	Yes

Product parameters

Parameter	Value	Parameter	Value
-----------	-------	-----------	-------

General product parameters:

Energy consumption in on-mode (kWh/1000 h), rounded up to the nearest integer	12	Energy efficiency class	E
Useful luminous flux (ϕ_{use}), indicating if it refers to the flux in a sphere (360°), in a wide cone (120°) or in a narrow cone (90°)	1 260 in Wide cone (120°)	Correlated colour temperature, rounded to the nearest 100 K, or the range of correlated colour temperatures, rounded to the nearest 100 K, that can be set	3 000 or 4 000 or 5 700
On-mode power (P_{on}), expressed in W	12,0	Standby power (P_{sb}), expressed in W and rounded to the second decimal	-
Networked standby power (P_{net}) for CLS, expressed in W and rounded to the second decimal	-	Colour rendering index, rounded to the nearest integer, or the range of CRI-values that can be set	80
Outer dimensions	Height	Spectral power distribution in the	See image in last page
	Width		

without separate control gear, lighting control parts and non-lighting control parts, if any (millimetre)	Depth	48	range 250 nm to 800 nm, at full-load	
Claim of equivalent power ^(a)		-	If yes, equivalent power (W)	-
			Chromaticity coordinates (x and y)	0,440 0,403
Parameters for directional light sources:				
Peak luminous intensity (cd)		556	Beam angle in degrees, or the range of beam angles that can be set	116
Parameters for LED and OLED light sources:				
R9 colour rendering index value		10	Survival factor	0,90
the lumen maintenance factor		0,96		

(a) '-': not applicable;

(b) '-': not applicable;

Product Information Sheet

COMMISSION DELEGATED REGULATION (EU) 2019/2015 with regard to energy labelling of light sources

Supplier's name or trade mark: Source

Supplier's address: SGD Limited, Unit 7/8 Ashbourne Business Centre, Ballybin Road, Ashbourne, Co. Meath. A84 YP58. Ireland.

Model identifier: SLIM SQ 18W CCT

Type of light source:

Lighting technology used:	LED	Non-directional or directional:	DLS
Light source cap-type (or other electric interface)	N/A		
Mains or non-mains:	NMLS	Connected light source (CLS):	No
Colour-tuneable light source:	No	Envelope:	-
High luminance light source:	No		
Anti-glare shield:	No	Dimmable:	Yes

Product parameters

Parameter	Value	Parameter	Value
-----------	-------	-----------	-------

General product parameters:

Energy consumption in on-mode (kWh/1000 h), rounded up to the nearest integer	18	Energy efficiency class	E
Useful luminous flux (ϕ_{use}), indicating if it refers to the flux in a sphere (360°), in a wide cone (120°) or in a narrow cone (90°)	1 910 in Wide cone (120°)	Correlated colour temperature, rounded to the nearest 100 K, or the range of correlated colour temperatures, rounded to the nearest 100 K, that can be set	3 000 or 4 000 or 5 700
On-mode power (P_{on}), expressed in W	18,0	Standby power (P_{sb}), expressed in W and rounded to the second decimal	-
Networked standby power (P_{net}) for CLS, expressed in W and rounded to the second decimal	-	Colour rendering index, rounded to the nearest integer, or the range of CRI-values that can be set	80
Outer dimensions	Height	Spectral power distribution in the	See image in last page
	Width		

without separate control gear, lighting control parts and non-lighting control parts, if any (millimetre)	Depth	40	range 250 nm to 800 nm, at full-load	
Claim of equivalent power ^(a)		-	If yes, equivalent power (W)	-
			Chromaticity coordinates (x and y)	0,440 0,403
Parameters for directional light sources:				
Peak luminous intensity (cd)		851	Beam angle in degrees, or the range of beam angles that can be set	117
Parameters for LED and OLED light sources:				
R9 colour rendering index value		10	Survival factor	0,90
the lumen maintenance factor		0,96		

(a) '-': not applicable;

(b) '-': not applicable;

Product Information Sheet

COMMISSION DELEGATED REGULATION (EU) 2019/2015 with regard to energy labelling of light sources

Supplier's name or trade mark: Source

Supplier's address: SGD Limited, Unit 7/8 Ashbourne Business Centre, Ballybin Road, Ashbourne, Co. Meath. A84 YP58. Ireland.

Model identifier: SLIM SQ 30W CCT

Type of light source:

Lighting technology used:	LED	Non-directional or directional:	DLS
Light source cap-type (or other electric interface)	N/A		
Mains or non-mains:	NMLS	Connected light source (CLS):	No
Colour-tuneable light source:	No	Envelope:	-
High luminance light source:	No		
Anti-glare shield:	No	Dimmable:	Yes

Product parameters

Parameter	Value	Parameter	Value
-----------	-------	-----------	-------

General product parameters:

Energy consumption in on-mode (kWh/1000 h), rounded up to the nearest integer	30	Energy efficiency class	E
Useful luminous flux (ϕ_{use}), indicating if it refers to the flux in a sphere (360°), in a wide cone (120°) or in a narrow cone (90°)	3 090 in Wide cone (120°)	Correlated colour temperature, rounded to the nearest 100 K, or the range of correlated colour temperatures, rounded to the nearest 100 K, that can be set	3 000 or 4 000 or 5 700
On-mode power (P_{on}), expressed in W	30,0	Standby power (P_{sb}), expressed in W and rounded to the second decimal	-
Networked standby power (P_{net}) for CLS, expressed in W and rounded to the second decimal	-	Colour rendering index, rounded to the nearest integer, or the range of CRI-values that can be set	80
Outer dimensions	Height	Spectral power distribution in the	See image in last page
	Width		

without separate control gear, lighting control parts and non-lighting control parts, if any (millimetre)	Depth	51	range 250 nm to 800 nm, at full-load	
Claim of equivalent power ^(a)		-	If yes, equivalent power (W)	-
			Chromaticity coordinates (x and y)	0,440 0,403
Parameters for directional light sources:				
Peak luminous intensity (cd)		1 323	Beam angle in degrees, or the range of beam angles that can be set	117
Parameters for LED and OLED light sources:				
R9 colour rendering index value		11	Survival factor	0,90
the lumen maintenance factor		0,96		

(a) '-': not applicable;

(b) '-': not applicable;

Disassembly precautions

When disassembling the LED light source, please always follow the basic safety precautions listed below

1. Read all instructions.
2. Professional people maintenance.
3. Always make sure that the power is turned off and the LED lamps have cooled down before disassembling, cleaning and adjusting the LED lamps.
4. Do not disassemble LED lamps near the heat source.
5. Turn on the LED lamp, confirm the voltage and current do not exceed the rated nominal value.

Safety instructions

WARNING!!!

1. Before disassembling, please make sure that the LED lamp is disconnected from the power supply.
2. To ensure that the LED is not damaged, please wear an effective static ring.
3. There is high temperature work during the disassembly process, please wear goggles, masks and protective gloves.



Product end of life instruction.

This Lighting product is in the scope of EU 2019/2020 directive on Waste Electrical and Electronic Equipment (WEEE). This product must be disposed according to the legislation. This document is intended for use by end of life recyclers or treatment facilities. It provides the basic information to assure an appropriate end of life treatment for the components and materials of the product. Please follow pictured diagram on the back of this manual showing how to dismantle the product into different components which should be disposed correctly. These components would consist of plastic, metal and electronic materials. It is the responsibility of the end user to dispose of this product correctly. www.weeeireland.ie or contact your local council for further information.

LED light source disassembly

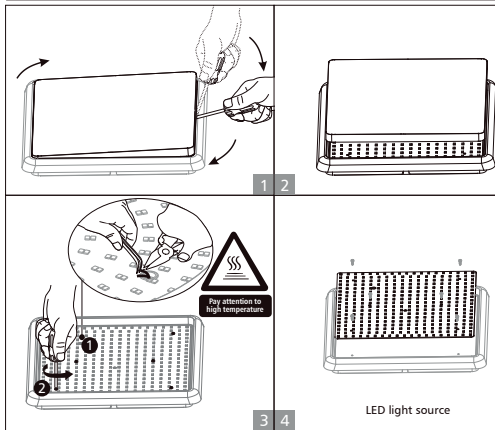

LED control gear disassembly

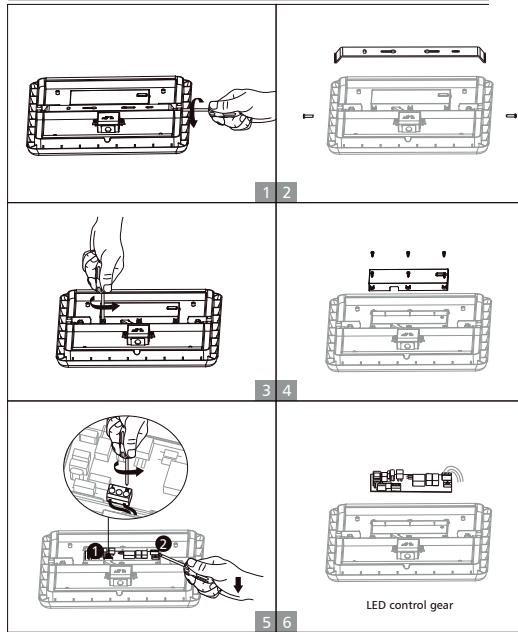

LED CEILING LIGHT USER GUIDE

SLIM-SQ CCT STANDARD MODELS
3 YEAR WARRANTY

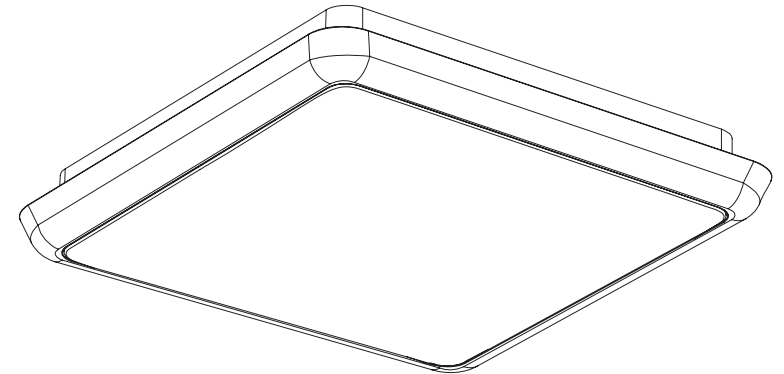

SLIM-SQ 12W CCT SLIM-SQ 18W CCT SLIM-SQ 30W CCT

For more information contact:

Unit 7/8 Ashbourne Business Centre, Ballybin Road, Ashbourne, Co. Meath, Ireland, A84 YP58, Phone: 00353 1 835 7447

Unit 32 Junction One Business Park, Valley Road, Birkenhead, Merseyside, UK, CH41 7ED, UK Ph: 0330 551 7000

Website: www.sgd.ie



Solas Geal Distribution



SAFETY INSTRUCTIONS

To ensure correct function and safety, please read and follow all instructions carefully before using the product:

1. Turn off power supply before installation or before doing any maintenance work.
2. Do not install any luminaire near the heat source.
3. IP grade please refer to product label, only IP54 can be used in damp locations.
4. Do not exceed the nominal supply voltage or amperage ratings.
5. Dimmable version could be compatible with a wide range of recommended TRIAC dimmers.
6. All wiring and installation of the light fitting must adhere to local and national wiring rules.
7. Take care not to pull any electrical wires during unpacking as this may damage the connection.
8. Lay out all the components on a smooth surface and make sure there are no components missing before assembling.
9. To avoid injury or damage to the fitting, please ensure that power leads and screws are secure before connecting the power.
10. Please keep instructions for future reference.

For non replaceable light sources:

The light source of this luminaire is not replaceable; when the light source reaches its end of life the whole luminaire shall be replaced.

Installation Procedure

WARNING

1. Switch off before installation.
2. Switch on only after complete installation and examination of the circuit.
3. Professional electrician for installation and maintenance only.

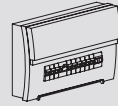

**Turn Off
Power Supply**

Turn Off power supply before starting any installation. Read instructions & check you have all the tools & accessories to complete the installation correctly.

Step 1

Take out the light and accessory pack from box.

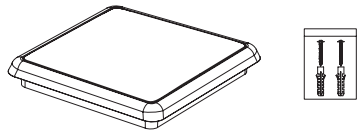

Step 2

Remove screw, take out bracket.

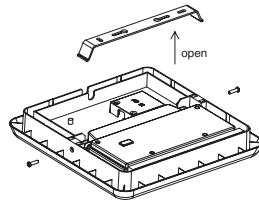

Step 3

(A) wiring diagram only for NON-emergency function light.

(B) wiring diagram only for Emergency function light.

Fix bracket with screws into the ceiling.

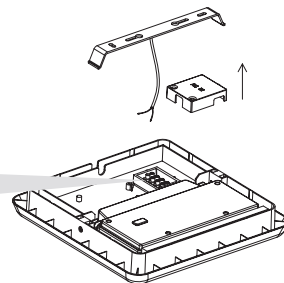
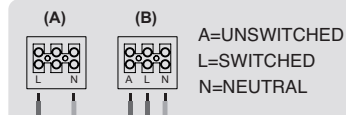

Step 4

For color changeable model (controlled by Slide Switch in lamp), please select light color before mounting to ceiling or wall, see below picture.

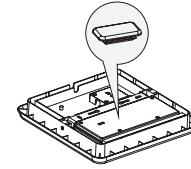

1. Take rubber stopper out from slide switch for color selection.

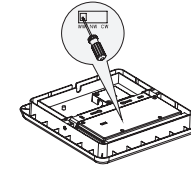

2. Choose color by slide switch with corresponding color temperature.

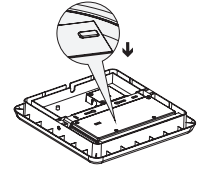

3. Insert rubber stopper back into slide switch properly.

Step 5

Mount ceiling light into the right place

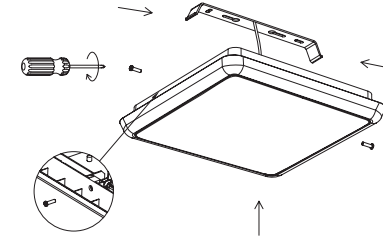

Step 6

Switch on

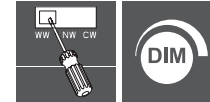
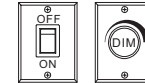
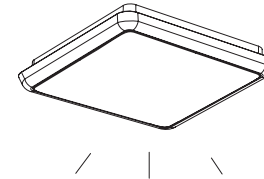

Colour Changeable (controlled by Slide Switch in lamp) and dimmable
Please select light colour before mounting to ceiling or wall

Important

- This product contains a light source of energy efficiency class D
- The product is double insulated so does not require an earth
- The driver is non isolated
- The light source is not replaceable inside the luminaire
- The control gear must be replaced by a qualified electrician

Spectrum Test Report

Sample
Specification : SLIM SQ 12W CCT @ (5700K)
Sample No. : 1
Manufacturer : SGD LIMITED

Date : 2021-10-21 09:31:39
Sam. Status :
Instrument : HAAS - 2000
Test by : SGD LIMITED

Test Condition

Temperature : 25.3Deg
WL Range : 350nm-780nm
Test Mode : Fast Test

RH : 65.0%
IP : 1692 (3%)
T : 10 ms
Sensitivity : High

Spectrum

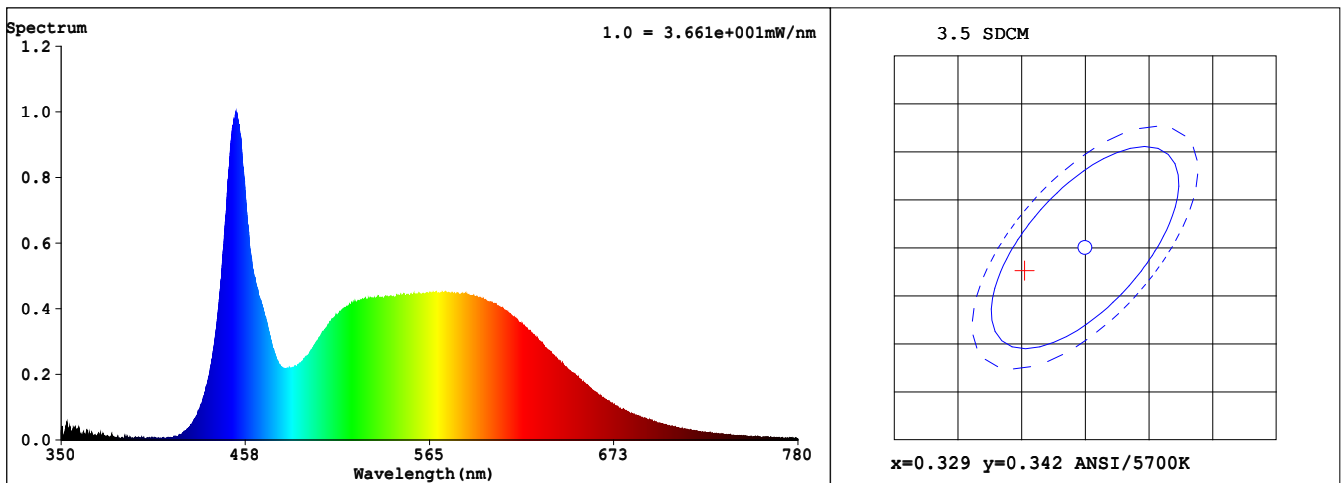

Colorimetric Parameters

Chromaticity Coordinate: $x = 0.3239$ $y = 0.3393$ / $u' = 0.2017$ $v' = 0.4754$ ($duv=3.00e-03$)

CCT= 5890K Prcp WL: $L_d=500.1nm$ Purity=2.9%

Peak WL: $L_p=452nm$ FWHM: =19.3nm Ratio:R=14.5% G=80.2% B=5.3%

Render Index: $R_a = 84.7$

R1 =83 R2 =90 R3 =92 R4 =84 R5 =84 R6 =85 R7 =89
R8 =71 R9 =15 R10=74 R11=84 R12=59 R13=85 R14=96 R15=79

Photometric & Radiometric Parameters

Flux = 1084.4 lm Eff. : 94.48 lm/W $F_e = 3.4795 W$

Electrical parameters

$V = 239.9 V$ $I = 0.05319 A$ $P = 11.48 W$ PF = 0.8995 F=49.99 Hz

Spectrum Test Report

Sample :
Specification : SLIM SQ 12W CCT@ (4000K)
Sample No. : 2
Manufacturer : SGD LIMITED

Date : 2021-10-21 09:32:34
Sam. Status :
Instrument : HAAS - 2000
Test by : SGD LIMITED

Test Condition

Temperature : 25.3Deg
WL Range : 350nm-780nm
Test Mode : Fast Test

RH : 65.0%
IP : 1242 (2%)
T : 10 ms
Sensitivity : High

Spectrum

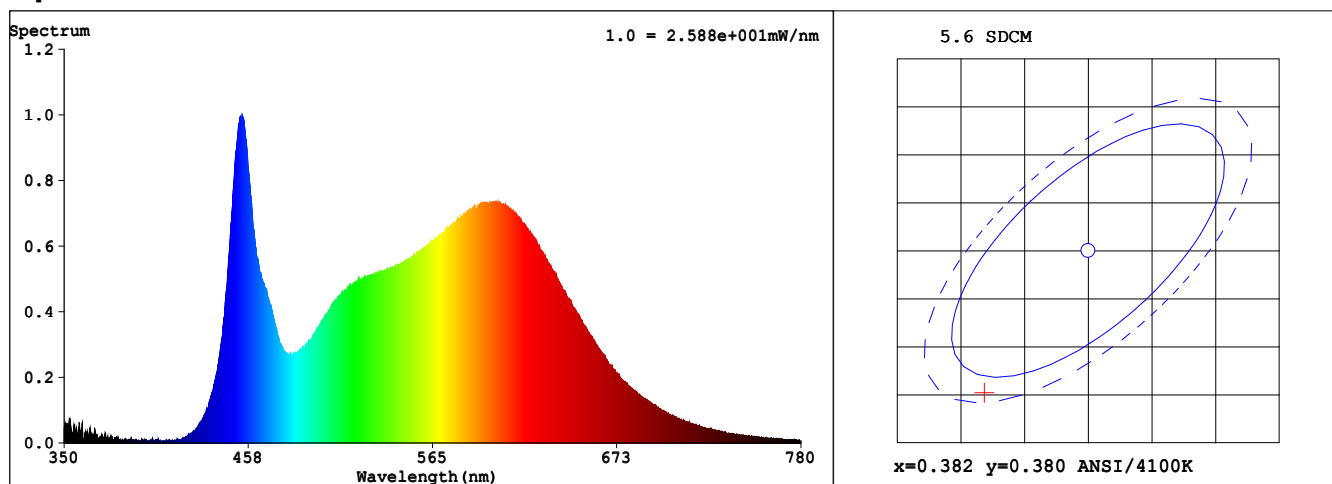

Colorimetric Parameters

Chromaticity Coordinate: $x = 0.3736$ $y = 0.3649$ / $u' = 0.2254$ $v' = 0.4952$ ($duv = -3.62e-03$)
CCT= 4105K Prcp WL: $L_d = 581.1\text{nm}$ Purity=21.6%
Peak WL: $L_p = 454\text{nm}$ FWHM: =20.4nm Ratio:R=19.0% G=76.6% B=4.3%

Render Index: $R_a = 87.4$

R1 =88 R2 =95 R3 =96 R4 =86 R5 =88 R6 =91 R7 =86
R8 =70 R9 =28 R10=87 R11=86 R12=67 R13=91 R14=99 R15=83

Photometric & Radiometric Parameters

Flux = 1080.8 lm Eff. : 96.56 lm/W $F_e = 3.4191\text{ W}$

Electrical parameters

V = 239.9 V I = 0.05210 A P = 11.19 W PF = 0.8956 F=49.99 Hz

Spectrum Test Report

Sample
Specification : SLIM SQ 12W CCT @ (3000K)
Sample No. : 3
Manufacturer : SGD LIMITED

Date : 2021-10-21 09:32:58
Sam. Status :
Instrument : HAAS - 2000
Test by : SGD LIMITED

Test Condition

Temperature : 25.3Deg
WL Range : 350nm-780nm
Test Mode : Fast Test

RH : 65.0%
IP : 1393 (2%)
T : 10 ms
Sensitivity : High

Spectrum

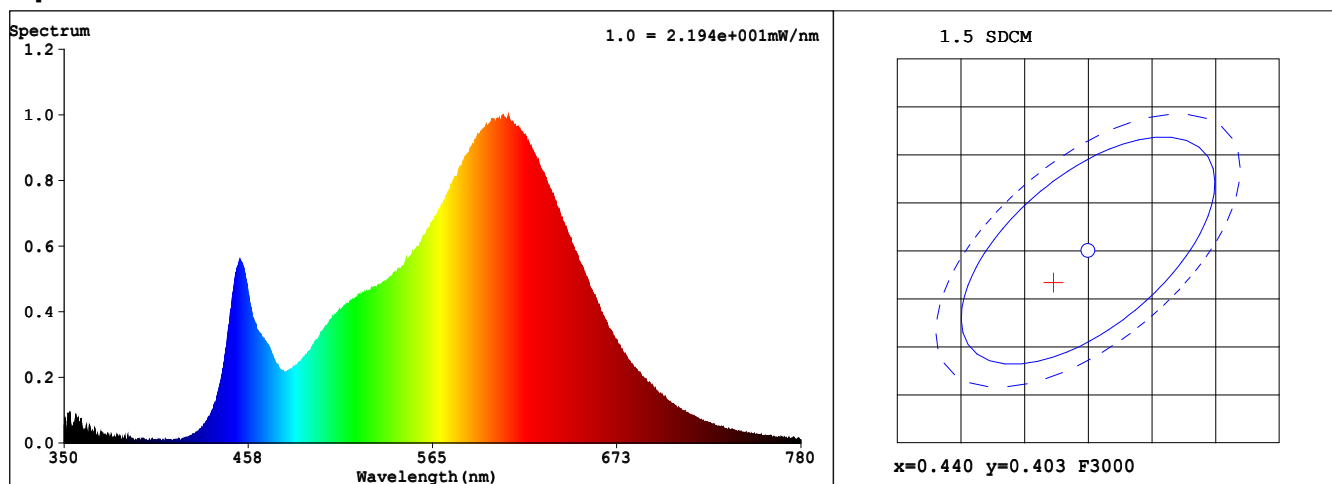

Colorimetric Parameters

Chromaticity Coordinate: $x = 0.4373$ $y = 0.3997$ / $u' = 0.2527$ $v' = 0.5197$ ($duv = -1.81e-03$)
CCT= 2958K Prcp WL: $L_d = 583.7\text{nm}$ Purity=51.2%
Peak WL: $L_p = 609\text{nm}$ FWHM: =117.0nm Ratio:R=23.7% G=73.4% B=2.9%

Render Index: $R_a = 84.1$

R1 =84 R2 =95 R3 =93 R4 =82 R5 =85 R6 =94 R7 =81
R8 =59 R9 =11 R10=88 R11=83 R12=78 R13=87 R14=97 R15=76

Photometric & Radiometric Parameters

Flux = 1026.3 lm Eff. : 89.81 lm/W $F_e = 3.1725$ W

Electrical parameters

V = 239.9 V I = 0.05300 A P = 11.43 W PF = 0.8989 F=49.99 Hz



EU DECLARATION OF CONFORMITY

Manufacturers Name: Solas Geal Distribution
Unit 7/8 Ashbourne Business Centre, Ballybin Road, Ashbourne, Co. Meath, A84 YP58.

Declaration Number:
058-SLIM SQ 12W CCT, 058-SLIM SQ 18W CCT, 058-SLIM SQ 30W CCT

This declaration of conformity is issued under the sole responsibility of the manufacturer.

Products:
12Watt ,18Watt & 30watt IP54 Dimmable Slim Line square led CCT luminaire

Model Number:
SLIM SQ 12W CCT, SLIM SQ 18W CCT, SLIM SQ 30W CCT.

The product/model of the declaration described above is in conformity with the relevant Community harmonisation legislation:

Low Voltage Directive (2014/35/EU)
EMC 2014/30/EU
RoHS (2011/65/EU)

The product/model of the declaration described above is in conformity with the standards and technical specifications listed below:

EN55015:2013+A1:2015, EN61547:2009, EN61000-3-2:2014, EN61000-3-3:2013, EN60598-1:2015, EN60598-2-1:1989, EN62493:2015



Signed:

Date:

Place of Issue: Republic of Ireland

