

Product Information Sheet

COMMISSION DELEGATED REGULATION (EU) 2019/2015 with regard to energy labelling of light sources

Supplier's name or trade mark: Source

Supplier's address: SGD Limited, Unit 7/8 Ashbourne Business Centre, Ballybin Road, Ashbourne, Co. Meath. A84 YP58. Ireland.

Model identifier: BULKLED30W

Type of light source:

Lighting technology used:	LED	Non-directional or directional:	NDLS
Light source cap-type (or other electric interface)	60 SMD		
Mains or non-mains:	NMLS	Connected light source (CLS):	No
Colour-tuneable light source:	No	Envelope:	-
High luminance light source:	No		
Anti-glare shield:	No	Dimmable:	No

Product parameters

Parameter	Value	Parameter	Value
-----------	-------	-----------	-------

General product parameters:

Energy consumption in on-mode (kWh/1000 h), rounded up to the nearest integer	30	Energy efficiency class	F
Useful luminous flux (ϕ_{use}), indicating if it refers to the flux in a sphere (360°), in a wide cone (120°) or in a narrow cone (90°)	2 200 in Wide cone (120°)	Correlated colour temperature, rounded to the nearest 100 K, or the range of correlated colour temperatures, rounded to the nearest 100 K, that can be set	2 700 or 4 000 or 6 500
On-mode power (P_{on}), expressed in W	30,0	Standby power (P_{sb}), expressed in W and rounded to the second decimal	-
Networked standby power (P_{net}) for CLS, expressed in W and rounded to the second decimal	-	Colour rendering index, rounded to the nearest integer, or the range of CRI-values that can be set	83
Outer dimensions without separate control gear, light-	Height	315	Spectral power distribution in the range 250 nm to 800 nm, at full-load
	Width	265	
	Depth	122	
			See image in last page

ing control parts and non-lighting control parts, if any (millimetre)			
Claim of equivalent power ^(a)	-	If yes, equivalent power (W)	-
		Chromaticity coordinates (x and y)	0,370 0,366
Parameters for LED and OLED light sources:			
R9 colour rendering index value	38	Survival factor	1,00
the lumen maintenance factor	-		

(a) '-': not applicable;

(b) '-': not applicable;

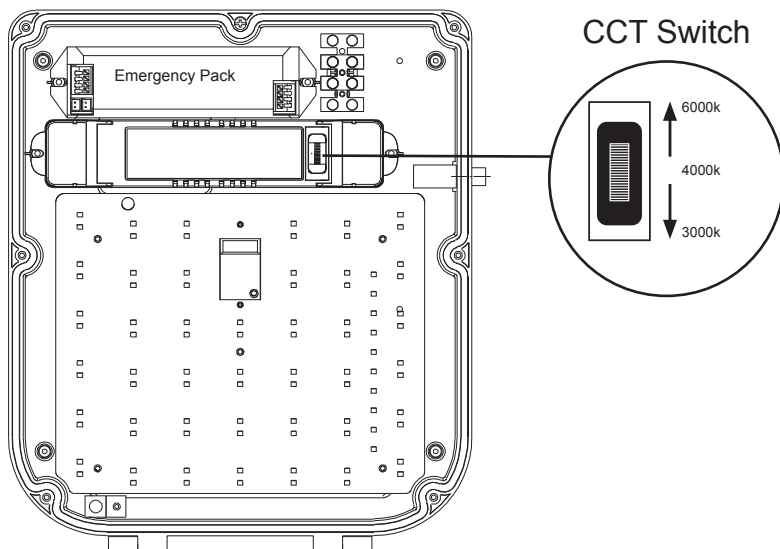

Installation Guide



Product end of life instruction.

This Lighting product is in the scope of EU 2019/2020 directive on Waste Electrical and Electronic Equipment (WEEE). This product must be disposed according to the legislation. This document is intended for use by end of life recyclers or treatment facilities. It provides the basic information to assure an appropriate end of life treatment for the components and materials of the product. Please follow pictured diagram on the back of this manual showing how to dismantle the product into different components which should be disposed correctly. These components would consist of plastic, metal and electronic materials. It is the responsibility of the end user to dispose of this product correctly. www.weeeireland.ie or contact your local council for further information.

Disassembly Diagram

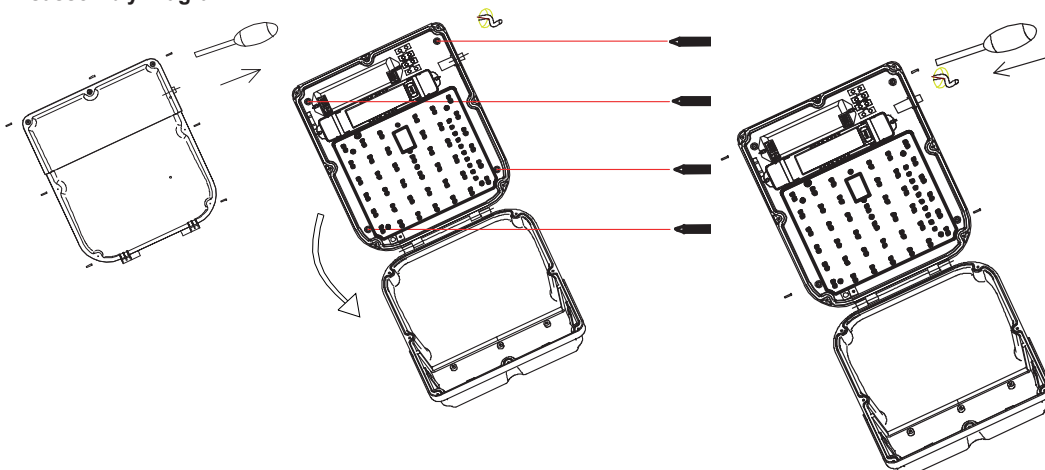

- BULK LED 30W**
- BULK LED 30W+PC**
- BULK 30W EMER**
- BULK 30W PC EMER**

For more information contact:

Unit 7/8 Ashbourne Business Centre, Ballybin Road, Ashbourne, Co. Meath, Ireland, A84 YP58,
Phone: 00353 1 835 7447
 Unit 32 Junction One Business Park, Valley Road, Birkenhead, Merseyside, UK, CH41 7ED,
UK Ph: 0330 551 7000
Website: www.sgd.ie



Solas Geal Distribution



Warning

- Please read these instructions carefully before commencing any work. This unit must be fitted by a Qualified Electrician.
- This is a Class 1 product and must be earthed.
- Install in accordance with IEE Wiring regulations and current building regulations.
- To prevent electrocution, switch off at mains supply before installing or maintaining this fitting. This light fitting should be connected to a circuit with a 30mA RCD fitted.
- If replacing an existing fitting, make a careful note of the connections.
- This system contains non-replaceable parts and cannot be serviced. If damage occurs the part should be scrapped.
- Waste electrical products should not be disposed of with household waste. Please recycle where facilities exist. Check with your local authority or retailer for recycling advice.
- This product is rated at IP65.
- This product is not suitable for dimming.

Product Code:	Voltage:	Lamp:	IP Rating:	Colour Rendering Index	CCT Choice:
BULK LED 30W	200-240V ~ 50/60Hz	30W 48PCs SMD	IP65	CRI>80	3000k, 4000k, 6000k
BULK LED 30W+PC	200-240V ~ 50/60Hz	30W 48PCs SMD	IP65	CRI>80	3000k, 4000k, 6000k
BULK 30W EMER	200-240V ~ 50/60Hz	30W 48PCs SMD	IP65	CRI>80	3000k, 4000k, 6000k
BULK 30W PC EMER	200-240V ~ 50/60Hz	30W 48PCs SMD	IP65	CRI>80	3000k, 4000k, 6000k

Layout

- Plan the desired layout of this fitting carefully, ensuring the cables will reach the distance between the junction box and the light fitting.
- Avoid locating any cables in positions that would cause a hazard. Position cables and junction boxes (not supplied) away from areas where they may be at risk from being cut, trapped or damaged.
- The mains supply cable must have a minimum cross sectional area of 1.0mm².
- Cables must be protected using suitable conduit or plastic trunking.
- The product can be wall or ceiling mounted.
- The correct fixings should be used for brick, cavity or plasterboard.

Installation Procedure for BULK 30W EMER/BULK 30W PC EMER

- Before installation turn off mains supply.
- Remove the 7 cover retaining screws, these are captive so can be left on the diffuser.
- Open the luminaire.
- Drill out the four fixing points, one per corner (A) and secure the luminaire using suitable fixings.
- Using a suitable cable gland, pass the supply cable through the cable gland and terminate the supply cable into the terminal block
- (Neutral - Blue, Earth - Green/Yellow, L - Brown, Permanent Live, & L` Brown Switched Live)
- Re-fit the front using the retained screws, ensuring the seal is in place and clean.
- Turn on mains supply and test.
- Ensure the luminaire is powered up for a minimum of 24 hours prior to carrying out any periodic testing.
- Once charging is complete a 3 hour discharge test should be carried out and the results recorded in accordance with current regulations.

Commissioning

- Ensure that the screws and cable entry points are sealed to maintain the IP rating of the product.
- Refit the shade and outer bezel and secure with the screws. Ensure the seals are correctly located.
- Replace fuse or circuit breaker and switch on. Your light is now ready for use.
- Fitting/Replacing Bulbs
- This system contains non-replaceable parts and cannot be serviced. If damage occurs the part should be scrapped.
- We recommend cleaning with a soft dry cloth.
- Do not use solvents or abrasive cleaners as these could damage the finish.

Recycling Advice

- Waste electrical products should not be disposed of with household waste.
- Please recycle where facilities exist. Check with your Local Authority or retailer for recycling advice.

Safety Information

- For your safety, always switch off the supply before cleaning.

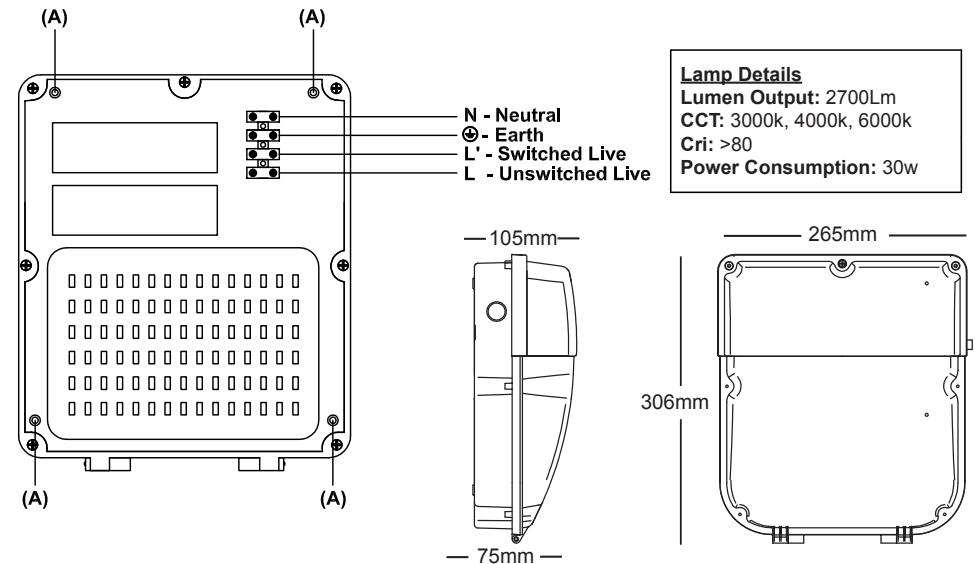

Fitting/Replacing Bulbs

- This system contains non-replaceable parts and cannot be serviced. If damage occurs the part should be scrapped.
- We recommend cleaning with a soft dry cloth.
- Do not use solvents or abrasive cleaners as these could damage the finish.

Recycling advice

Waste electrical products should not be disposed of with household waste. See back page for details

Safety Information

- For your safety, always switch off the supply before cleaning.

Spectrum Test Report

Sample : BULK LED 30W EMER
Sample No. : 9
Manufacturer : SGD LIMITED

Date : 2021-12-30 09:35:13
Sam. Status :
Instrument : HAAS-2000

Test Condition

Temperature : 25.3Deg
WL Range : 350nm-1000nm
Test Mode : Fast Test

RH : 65.0%
IP : 53589 (82%)
T : 267 ms
Sensitivity : High

Spectrum

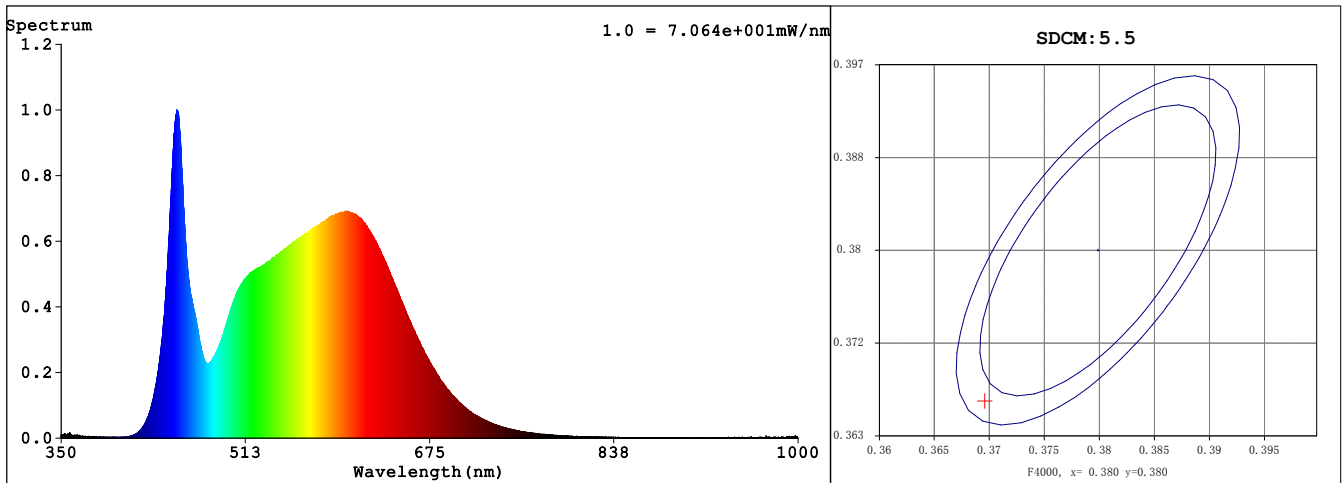

Colorimetric Parameters

Chromaticity Coordinate: $x = 0.3697$ $y = 0.3663$ / $u' = 0.2222$ $v' = 0.4953$ ($duv = -1.68e-03$)

CCT= 4234K Prcp WL: $L_d = 579.3\text{nm}$ Purity=20.9%

Peak WL: $L_p = 452\text{nm}$ FWHM: =18.5nm Ratio:R=18.6% G=77.3% B=4.1%

Render Index: $R_a = 88.5$

R1 =88	R2 =93	R3 =95	R4 =88	R5 =88	R6 =89	R7 =90	
R8 =76	R9 =38	R10=83	R11=88	R12=66	R13=90	R14=98	R15=84

Photometric & Radiometric Parameters

Flux = 2958.8 lm Eff. : 111.23 lm/W Fe = 9.4771 W

Electrical parameters

V = 230.1 V I = 0.1242 A P = 26.60 W PF = 0.9311 F=49.99 Hz



EU DECLARATION OF CONFORMITY

Manufacturers Name: Solas Geal Distribution
Unit 7/8 Ashbourne Business Centre, Ballybin Road, Ashbourne, Co. Meath, A84 YP58.

Declaration Number:
026-BULKLED30W,026-BULKLED30W+PC,026-BULKLED30W EMER, 026-BULKLED 30W PC
EMER

This declaration of conformity is issued under the sole responsibility of the manufacturer.

Products:
LED OUTDOOR BULKHEAD, IP65 30watt Wallpack

Model Number:
BULKLED30W, BULKLED30W+PC, BULKLED30W EMER, BULKLED 30W PC EMER

The product/model of the declaration described above is in conformity with the relevant
Community harmonisation legislation:

Low Voltage Directive (2006/95/EC)

The product/model of the declaration described above is in conformity with the standards
and technical specifications listed below:

EN6058-2-1:1989, EN60598-1:2015, EN61347-2-13:2014, EN61347-
1:2008+A1:2011+A2:2013, EN62471:2008/EN 61493:2010



Signed:

Date: 29/08/23

Place of Issue: Republic of Ireland

